

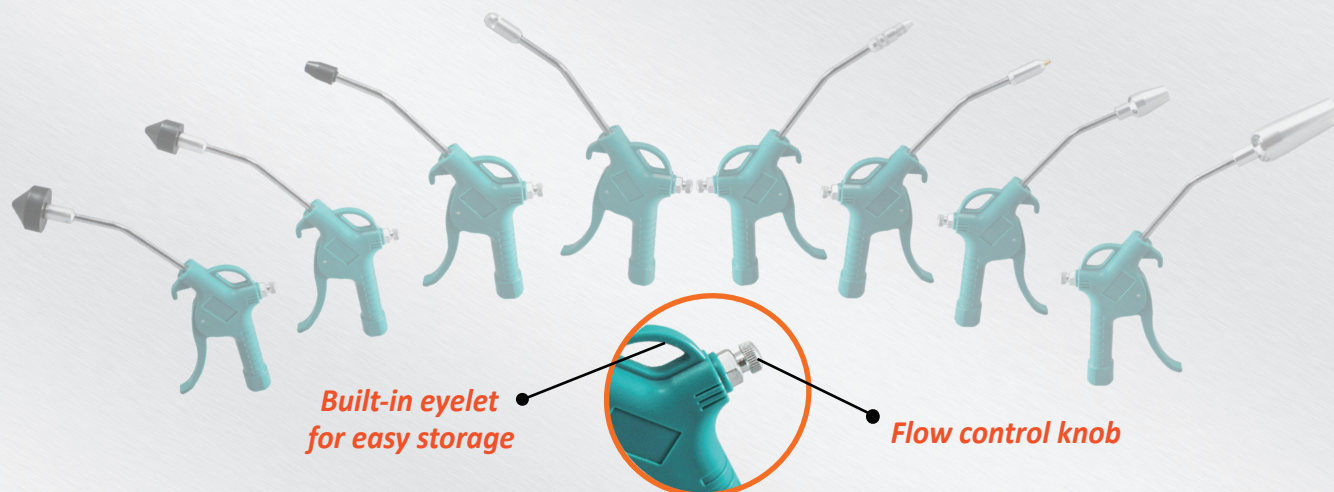

- **Composite, Light weight and High flow blow gun**
- **On body air volume control - quick, easy flow adjustment**
- **Diverse nozzles to satisfy multiple jobs and stric clean requirement**



Blow Gun with nozzle	Nozzle	Gun Weight g / oz	Flow Capacity CFM / LPM	Blow Gun with nozzle	Nozzle	Gun Weight g / oz	Flow Capacity CFM / LPM
A216 P2-1	1/2" Rubber Tip	137 (4.8)	10.5 (297)	A216 P3-2	Venturi Tip	144 (5.1)	21.2 (600)
A216 P2-2	1" Rubber Tip	153 (5.4)	10.0 (283)	A216 P5-1	Double High Flow Tip	152 (5.4)	30.3 (858)
A216 P2-3	1-3/8" Rubber Tip	162 (5.7)	8.0 (227)	A216 P5-2	Triple High Flow Tip	197 (6.9)	46.4 (1314)
A216 P3-1	Bypass Tip	140 (4.9)	15.6 (442)	A216 P6	Adjustable Flow Tip	142 (5.0)	8.6 (244)

• Working presure: 6.2 Bar (90 PSI) • Max. Pressure: 9.8 Bar (142 PSI) • Flow Capacity @ 90 PSI • Air inlet: 1/4"

Bypass nozzle

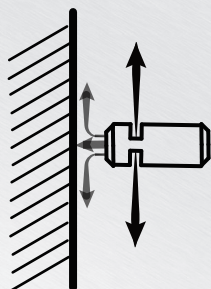

When fore-end air flow is blocked, pressure released through side outlet; reducing pressure for user safety.

Venturi nozzle

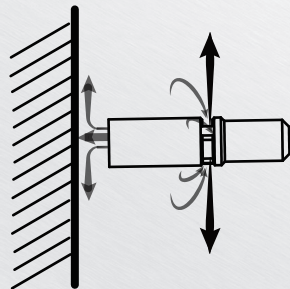

Air flow increases when passes through nozzle. Ambient air is drawn in side ports increases air velocity and volume for extra-high flow. Pressure released through side outlet for user protection when fore-end air flow blocked.

High Flow nozzle

Side venturi ports draw in additional air volume increase more air flow; produce stronger cleaning power.

Triple high flow achieves 1200 LPM (43.0 CFM)

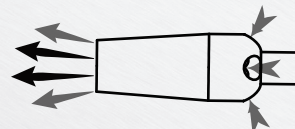

Optional application (A216Q)

